

A.O. SMITH

WATER PRODUCTS COMPANY

PSD-3-549
GAS

RESIDENTIAL WATER HEATERS REPLACEMENT PARTS LIST

MODELS: FCG/PCG 75 - 100 &
CGX/PCGX/SGX/PSGX-75
SERIES 270

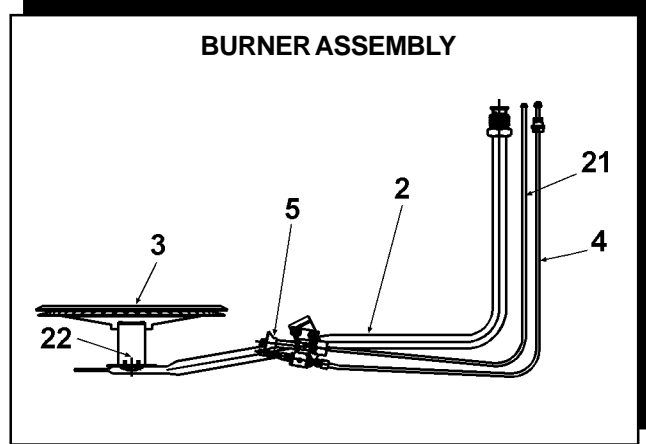
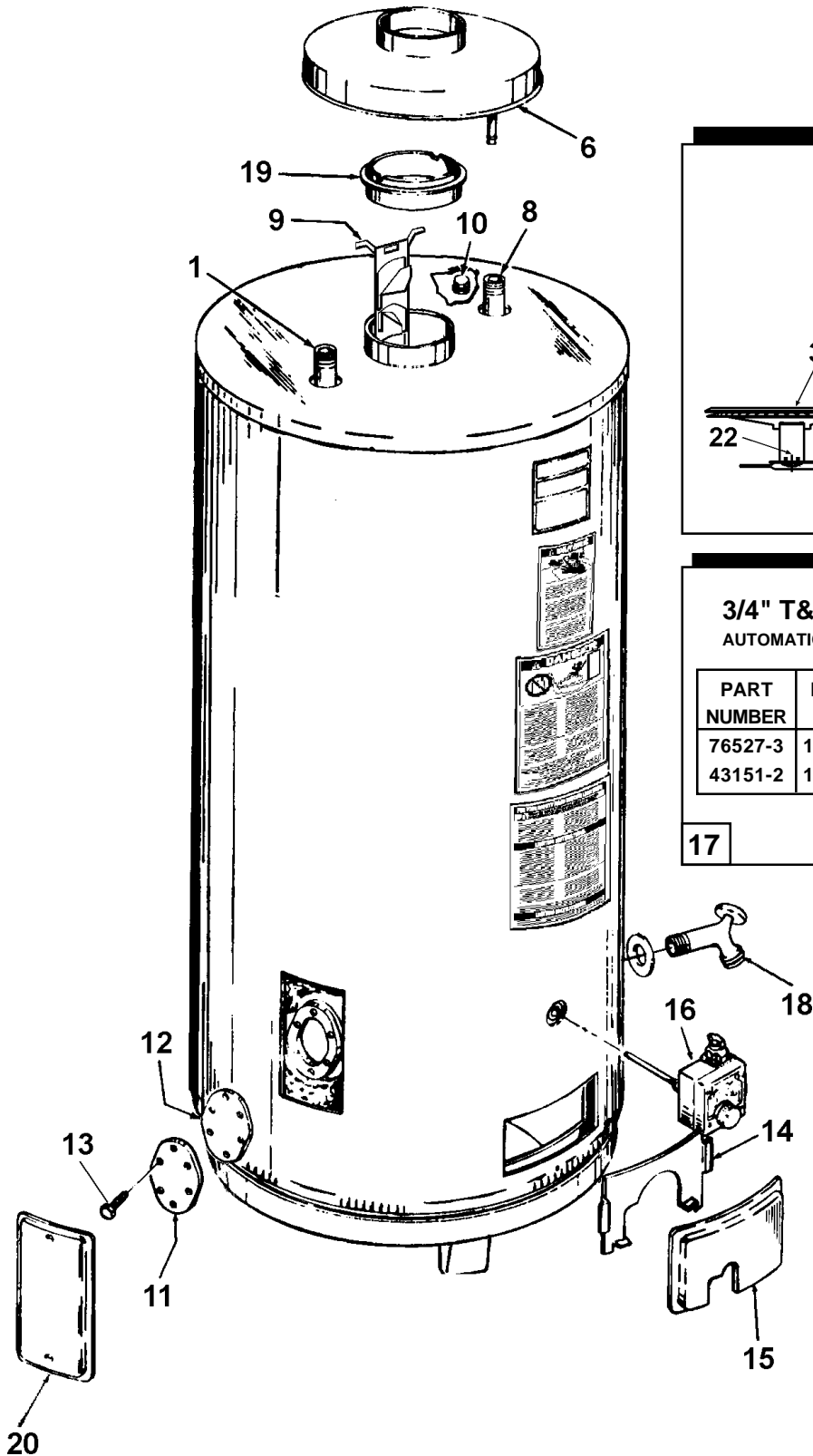

3/4" T&P RELIEF VALVE

AUTOMATIC, SELF-CLOSING TYPES

PART NUMBER	PRESS.	A =	TEMP RELIEF
76527-3	150 LBS.	2.13"	210°F
43151-2	150 LBS.	1.88"	210°F

17

A.O. SMITH WATER PRODUCTS COMPANY

5621 W. 115TH STREET • ALSIP, ILLINOIS 60803

PHONE: 1-800-433-2545 • FAX: 1-800-433-2515

Website: www.hotwater.com • E-mail: parts@hotwater.com

**FCG/PCG/ CGX/
PCGX/SGX/PSGX-75**

FCG/PCG-100

Item	Qty.	Description	Natural	Natural
1	1	Pipe Nipple	194139-1	194135-1
2	1	Burner Tube	194561-1	194561-1
3	1	Burner Head	194549	194549
4	1	Thermocouple	194621	194621
5	1	Pilot	<u>194550-2</u>	<u>194550-2</u>
* 6	1	Draft Hood	39072-4	39072-4
7	3	Draft Hood Brace	194309	194309
8	1	Inlet Tube	194891	194891-1
9	4	Flue Baffle Assembly	196172	196172
10	1	Anode Rod	183523-36	183523-48
11	1	Cleanout Cover (optional)	99037	99037
12	1	Cleanout Gasket (optional)	99038	99038
13	1	Cleanout Screw (optional)	69852-1	69852-1
14	1	Inner Door	39923	39923
15	1	Outer Door	39112-1	39112-1
16	1	Thermostat	<u>182791-3</u>	<u>182791-1</u>
17	1	T & P Relief Valve	43151-2	76527-3
18	1	Drain Valve	26273-6	26273-7
19	1	Flue Reducer	N/A	35405
20	1	Front Cover (optional)	181260	181260
21	1	Pilot Tube	<u>1417-60</u>	<u>1417-60</u>
* 22	1	Orifice	181508-21	181508-21
* 23	1	Fitting Breakaway	32365	32365
24	1	Manual	196223	196223

* Not Illustrated

Part numbers underlined are recommended stock items for emergency replacement.

(Consider gas used in your area only).



A.O. SMITH
WATER PRODUCTS
COMPANY

A.O. SMITH WATER PRODUCTS COMPANY
5621 W. 115TH STREET • ALSIP, ILLINOIS 60803
PHONE: 1-800-433-2545 • FAX: 1-800-433-2515
Website: www.hotwater.com • EMAIL: parts@hotwater.com